



Monthly Newsletter

Volume 21 Issue 6

President's Message

By: Tony Rome

50 Years!!! I still can't believe what happened in the postseason and the Super Bowl for the Chiefs! Congrats to the team, its fans and the whole Kansas City metro. Just think, it took the Chiefs as long to get back and win a superbowl as the typical lifespan of Concrete pavement. Let's hope it doesn't take that long again.

Now that football is over, February is here and that means we are busy, busy, busy with KSPE events. We hosted the bridge building competition and served Harvesters on February 1 and held the Mathcounts competition on February 4. If you helped to plan one of those events or volunteered, Thank You! If you weren't able to attend the events, don't worry, there are still plenty of opportunities right around the corner.

E-Week Luncheon

Engineers Week Luncheon will be on Friday, February 21. If you are interested in helping out that day, please contact me at tony.rome@opkansas.org. If you or your company haven't signed up yet, please do so. Join us while we celebrate our profession and present awards for Bridge Building, Mathcounts and Engineer of the Year.

Legislative Luncheon

Our annual trip to Topeka has been set for Monday, February 24th. Please consider attending to meet with your elected officials about our goals and concerns. Registration details are in this newsletter.

In this Issue

President's Message (p.1-2)
E-Week Celebration (p. 3)
Statehouse Visit (p. 4)
KSPE Awards (p. 5)

News and Events (p. 6)
Souper Bowl of Caring (p. 7)
Bridge Building (p. 8)
Meeting Minutes (p. 9-10)

Treasurer's Report (p. 11)
Chapter Leadership (p. 13-14)
Professional Directory (p. 15-16)

President's Message Continued

March Meeting

The annual March Madness social will be on Thursday, March 19. Come to watch some basketball and bring a non-member to introduce them to KSPE.

Awards

Please take some time to make nominations for annual KSPE awards. Note, there is not a requirement for an award recipient to be a KSPE member, but it is encouraged.

Board Member Nominations

We are taking nominations for upcoming 2020 – 2021 Officers to serve on the Board.

The one opening is for Secretary. If you would like to know more about the responsibilities or have questions, please contact me at tony.rome@opkansas.org.

Enjoy the long lasting celebration of the Chiefs victory and have a great February!

The goal of KSPE is to promote, recognize, and enhance the engineering profession by delivering professional development products and services, encouraging licensure, and advocating legislation and public policy for the betterment of human welfare and the profession.

KSPE E-Week Celebration

MSPE WESTERN CHAPTER & KSPE EASTERN CHAPTER, CO-SPONSORS
CORDIALLY INVITE YOU AND YOUR FIRM TO JOIN US AT THE
69TH ANNUAL ENGINEERS WEEK CELEBRATION

Date:

Friday, February 21, 2020

Time:

10:00 AM Booth set-up

10:30 AM Exhibits open & Networking

11:30 AM Luncheon

12:00 PM Awards

12:30 PM Presentation

Location:

Downtown Marriott Muehlebach Tower

Imperial/Colonial Ballroom

200 West 12th Street

Kansas City, MO 64105

Parking:

Barney Allis Plaza Central Garage or Marriott Hotel Parking

Discounted parking available at rate of \$7 per vehicle. Vouchers provided day of event.

Reservations:

Please use this [Registration Link](#) to register and find additional information for the event.

Must be received by 12:00 PM, Friday, February 14, 2020

Program:

The Engineer of the Year from KSPE Eastern Chapter and Young Engineer of the Year from MSPE Western Chapter and the top student winners from MathCounts, Bridge Building and Future Cities competitions will be honored. Following the awards will be a presentation by our Keynote Speaker.

Keynote Speaker:

ENR Midwest Editor and Associate Technology Editor Jeff Yoders has been writing about design and construction innovations for 20 years. He is a two-time Jesse H. Neal award winner and multiple ASBPE winner for his tech coverage. Jeff previously launched Building Design + Construction's building information modeling blog and wrote a geographic information systems column at CE News. He also wrote about materials prices, construction procurement and estimation for MetalMiner.com. He lives in Chicago, the birthplace of the skyscraper, where the pace of innovation never leaves him without a story to chase.

KSPE Statehouse Visit

KSPE Eastern Chapter Statehouse Visit Annual Legislative Luncheon

Eastern Chapter will have their Annual Lunch Meeting with the Johnson County Legislative Delegation on Monday, February 24, 2020. The lunch will be at the State Capital Building in Topeka, and will be preceded by a briefing in Braden Heidner Lowe & Associates office.

It is vital for us to let our concerns and priorities be known to our Senators and Representatives. This is an opportunity for us to meet our Representatives and Senators one-on-one and enjoy valuable 'face-time' with many of the people who represent us in Topeka.

Please put February 24th on your calendar and plan to take advantage of this opportunity to talk with our lawmakers.

Date:	Monday, February 24, 2020
Itinerary:	10:30 – 11:30 Legislative briefing at Braden Heidner Lowe & Associates office, 825 S. Kansas Ave., Ste. 500
	11:30 – 11:45 Walk to Capital
	11:45 – 1:00 Johnson Co. Delegation, Rm.TBD, Capital Bldg. for networking and luncheon
	1:00 Adjourn
Cost:	\$35 for members, \$40 for non-members Catered lunch TBD
RSVP for Luncheon:	by Wednesday, February 19th
Carpooling:	To Be Determined. If interested, please contact Charlie Love at 913-477-7660 or clove@lenexa.com
Register online:	KSPE Statehouse Visit Event Link

KSPE Awards

The KSPE Eastern Chapter is seeking nominations for this year's awards.

Engineer of the Year nominations are due by January 15th, 2020. All other nominations are due no later than March 15, 2020.

Nomination forms can be found on KSPE's website (<http://www.kansasengineer.org/Awards>).

Please submit your nominations to Ryan DaMetz at rdametz@gmail.com.

The Eastern Chapter award recipients will also be submitted on April 1, 2020 to KSPE for the State awards.

Award Categories

- Young Engineer of the Year
- Government Engineer of the Year
- Intern Engineer of the Year
- KSPE Award
- Outstanding Engineering Achievement
- Professional Development
- Outstanding Citizen
- Outstanding Teacher

The goal of KSPE is to promote, recognize, and enhance the engineering profession by delivering professional development products and services, encouraging licensure, and advocating legislation and public policy for the betterment of human welfare and the profession.

KSPE News and Events

KSPE Eastern Chapter worked with KC STEM Alliance to accept grant applications for STEM related curriculum and activities. We were thrilled to receive numerous applications and honored to provide over \$3,000 in grants to six local schools. KSPE is a proud supporter of initiatives that promote interest in STEM related careers, especially engineering.

Please help us spread the word that we will accept applications next fall for our 2021 grants.

Heritage Christian Academy	Middle School Math Project
Kansas City Kansas School District	Supplies for PLTW Courses
Olathe School District	Expand PLTW Courses
Piper School District	Aquaponics System
Resurrection School	Expand PLTW Courses
Shawnee Mission School District	Summer Engineering Program for Girls

ITS Heartland, an organization whose mission is “to improve the quality of life for those transportation users who live and invest in America’s Heartland Region through advanced transportation technologies and communications” has partnered with the Mobility On Demand Alliance (MOD) to host a forum where we will be showcasing successes and tackling some of the key issues facing MOD’s rapid transformation of how we move.

During the forum we will engage in panel and roundtable discussions that:

- Frame the Building Blocks of MOD
- Examine the MOD Opportunities in Missouri/Kansas
- Enable MOD: The Public and Private Sector Perspective

Examples of Mobility on Demand (MOD) are Uber/Lyft, RideKC Freedom, Scooters, Bike Share, etc. With the oncoming Autonomous Vehicle technology a lot of the MOD will become autonomous.

The cost is \$20 to cover the provided continental breakfast and lunch.

Please contact Kurt Rotering for more information
KRotering@walterpmoore.com or 816.701.2104

Souper Bowl of Caring

KSPE Eastern Chapter's community service event took place on Saturday, February 1, 2020.

Volunteers participated in Harvester's Souper Bowl of Caring to help feed the hungry in our area. We had 11 volunteers and our first time in the clean room. We got "geared up" and bagged and boxed nearly 1000 lbs of rice. We then sat together and ate a bowl of soup that symbolizes the only meal a food insecure person may get that day. Harvesters serves a 26 county area where 13.3% of people (1 in 8) is food insecure, with children among those most in need. If you were unable to join us on Saturday, please consider making a donation by visiting <https://www.harvesters.org/>.



Bridge Building

Thanks volunteers again for your help this year; we couldn't do it without you!

Mark Johnston

2020 KSPE MODEL BRIDGE BUILDING CONTEST

No.	Student	Instructor	School	Grade	Bridge Wt (g)	Load (g)	Ratio	Notes
1	Christian Cassell	R. Hetzel	Saint Thomas Aquinas	12	13.0	19716	1516.6	
2	Alex Kelley	R. Hetzel	Saint Thomas Aquinas	9	9.0	13492	1499.1	
3	Elysia Valverde	M. Hunting	Gardner Edgerton	11	16.0	23096	1443.5	

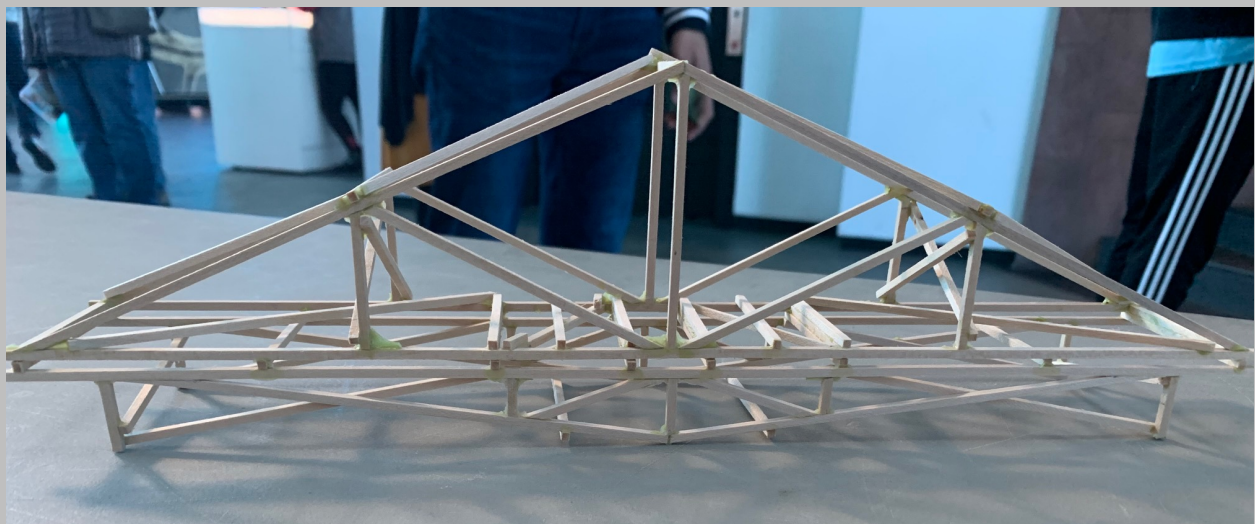
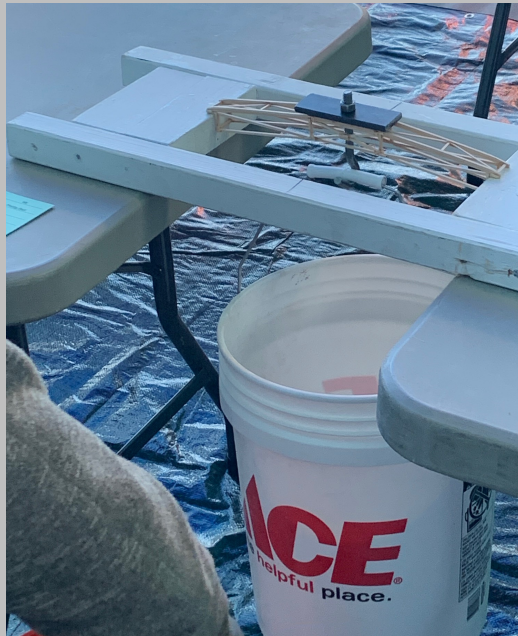

January Meeting Minutes



™ EASTERN CHAPTER
KANSAS SOCIETY OF
PROFESSIONAL ENGINEERS

January Board Meeting Minutes

Thursday, January 16, 2020

Attendees: Tony Rome, Kurt Rotering, Charlie Love, Kristen Leathers-Gratton, Cody Porter, Darren Meyer, Rod Holcomb, Ryan DaMetz, Allison Bruner, Tawn Nugent

Call to Order at 1:02 pm

- Approve agenda

Committee Reports:

- Legislative – *Annual legislative delegation lunch is set for 2/24. Planning to adjust prices for inflation. Tony encouraged board members to invite leaders of their organizations to attend.*
- MATHCOUNTS – *To be held 2/4. Tony and Rachel working through final preparations. 216 students signed up so far. May need additional volunteers. Rachel will send out email if necessary.*
- Model Bridge Building – *30 less students as of now. Set for 2/1 at Prairie Fire. Needs to get sample bridge and the KSPE banner. Good to go on volunteers so far.*
- Fundraising – *Checks for Rachel. Will mail them. Asked if he should make another sponsor board. Answer is yes. Will send jpg of sponsors to Kurt for the E-Week ppt.*
- Membership – *3 new members (141 total). Met with small group to discuss membership strategies.*
- Awards – *Has received nominations for a couple of categories. Board discussed EOY award and voted on recipient.*
- Young Engineers – *Starting to plan the summer event*
- Engineering Preparation – *Tawn provided high level overview on how the new process went this year. Full disbursement of funds to 5 or 6 organizations.*
- Engineer's week – *Most of the important details are resolved for the event. Working on day of details now. Will most likely be opportunities to volunteer the day of.*
- Advertising – *No report*
- Community Service Project(s) – *To be held on 2/1. Kurt said there are 11 people signed up so far.*
- State Director – *No report*

Reports

- Treasurer's Report – *Provided to members and is attached.*

Chapter Meetings

- February: E-week Luncheon – *February 21st*
- March: March Madness event – *March 19th at Coach's in Overland Park.*

Rotering

The goal of KSPE is to promote, recognize, and enhance the engineering profession by delivering professional development products and services, encouraging licensure, and advocating legislation and public policy for the betterment of human welfare and the profession.

January Meeting Minutes Continued



-
- April: Joint meeting with MSPE/SAME planned by SAME?
 - May: Awards meeting – St. Andrews, Overland Park, Date TBD.
 - June: Summer Social
 - State Conference: June in Kansas City

Old/New Business

Rome

- 2020 State KSPE Conference will be in Kansas City. Eastern Chapter to aid in planning efforts. *If there are any speaker / topic ideas, please forward to Charlie.*
- Open forum
- EOY Awards
- Newsletter deadline – January 30.

The goal of KSPE is to promote, recognize, and enhance the engineering profession by delivering professional development products and services, encouraging licensure, and advocating legislation and public policy for the betterment of human welfare and the profession.



**Kansas Society of Professional Engineers - Eastern Chapter
Treasurer's Report: December 2019**

Beginning Balances Date: December 1, 2019
Ending Balances Date: December 31, 2019

Checking Account

Beginning Balance		\$ 3,175.46
<i>Deposits</i>	None	\$ -
	Total Deposits	\$ -
<i>Withdrawals</i>	Check 1247 - Executive Secretary	\$ 200.00
	Check 1248 - Nov. Chiefs Social - Barley's Brewhaus (Cody P.)	\$ 499.22
	Check 1249 - E-week postage (Tony R.)	\$ 262.50
	Total Withdrawals	\$ 961.72
Ending Balance		\$ 2,213.74

Savings Account

Beginning Balance		\$ 14,504.11
<i>Deposits</i>	Interest	\$ 6.36
	Total Deposits	\$ 6.36
<i>Withdrawals</i>	None	\$ -
	Total Withdrawals	\$ -
Ending Balance		\$ 14,510.47

Money Market

Beginning Balance		\$ 5,572.61
<i>Deposits</i>	Interest	\$ 5.75
	Total Deposits	\$ 5.75
<i>Withdrawals</i>	None	\$ -
	Total Withdrawals	\$ -
Ending Balance		\$ 5,578.36

Cash on Hand

Beginning Balance		\$ 100.00
<i>Deposits</i>	None	\$ -
	Total Deposits	\$ -
<i>Withdrawals</i>	None	\$ -
	Total Withdrawals	\$ -
Ending Balance		\$ 100.00

EFK Account

Beginning Balance		\$ 7,480.10
<i>Deposits</i>	None	\$ -
	Total Deposits	\$ -
<i>Withdrawals</i>	None	\$ -
	Total Withdrawals	\$ -
Ending Balance		\$ 7,480.10

Rachel E. Henkhaus

Total \$ 29,882.67

Rachel E. Henkhaus, PhD, PE, Treasurer KSPE EC
December 31, 2019

Treasurers Report

January 2020



Kansas Society of Professional Engineers - Eastern Chapter Treasurer's Report: January 2020

Beginning Balances Date: January 1, 2020
Ending Balances Date: January 30, 2020

Checking Account

Beginning Balance			\$	2,213.74
<i>Deposits</i>	January Meeting - Eventbrite	\$	678.90	
	MSPE check for 2019 E-week for EFK	\$	375.00	
	Bridge Building - Kit sales	\$	430.00	
	Total Deposits	\$	1,483.90	
<i>Withdrawals</i>	Check 1250 - Executive Secretary	\$	200.00	
	Check 1251 - Nov. Dinner Meeting - OP/Sykes deposit (Kurt)	\$	150.00	
	Debit - Mathcounts - Trophies - Sports Awards	\$	444.13	
	Check 1252 - Bridge Building - Kit purchase (Lochner)	\$	240.04	
	Check 1253 - EFK passthrough - MSPE check for 2019 E-week	\$	375.00	
	Total Withdrawals	\$	1,409.17	
Ending Balance			\$	2,288.47

Savings Account

Beginning Balance			\$	14,510.47
<i>Deposits</i>	Interest	\$	5.76	
	Total Deposits	\$	5.76	
<i>Withdrawals</i>	None	\$	-	
	Total Withdrawals	\$	-	
Ending Balance			\$	14,516.23

Money Market

Beginning Balance			\$	5,578.36
<i>Deposits</i>	Interest	\$	4.26	
	Total Deposits	\$	4.26	
<i>Withdrawals</i>	None	\$	-	
	Total Withdrawals	\$	-	
Ending Balance			\$	5,582.62

Cash on Hand

Beginning Balance			\$	100.00
<i>Deposits</i>	None	\$	-	
	Total Deposits	\$	-	
<i>Withdrawals</i>	None	\$	-	
	Total Withdrawals	\$	-	
Ending Balance			\$	100.00

EFK Account

Beginning Balance			\$	7,480.10
<i>Deposits</i>	E-week 2019 from MSPE-EC	\$	375.00	
	EFK Fundraising	\$	700.00	
	Total Deposits	\$	1,075.00	
<i>Withdrawals</i>	None	\$	-	
	Total Withdrawals	\$	-	
Ending Balance			\$	8,555.10

Rachel E. Henkhaus

Total \$ **31,042.42**

Rachel E. Henkhaus, PhD, PE, Treasurer KSPE EC
January 30, 2020

Chapter Leadership

President

Tony Rome, P.E.
City of Overland Park
8500 Santa Fe Drive
Overland Park, KS 66212
913-895-6001
913-895-5055 (Fax)
tony.rome@opkansas.org

Vice President

Kurt Roterling, P.E.
Walter P Moore
1100 Walnut, Suite 1825
Kansas City, MO 64106
816-701-2104
krotering@walterpmoore.com

Treasurer Sr. Director

Rachel Henkhaus, PhD, P.E.
Garver
7301 W 129th Street
Suite 330
Overland Park, KS 66213
816-298-6465
REHenkhaus@GarverUSA.com

Secretary

Chad Hall, P.E.
HDR Engineering
10450 Holmes RD Suite 600
Kansas City, MO 64131
816-360-2731
chad.hall@hdrinc.com

Past President State Director

Charlie Love, P.E.
City of Lenexa
7700 Cottonwood
Lenexa, KS 66216
913-477-7660
clove@lenexa.com

Jr. Director Young Engineers

Cody Porter
Wilson & Co
800 E 101st Ter, Suite 200
Kansas City, MO 64131
816-701-3100
cody.porter@wilsonco.com

Director Model Bridge

Mark L. Johnston, P.E.
Lochner
16105 W 113th Street,
Suite 107
Lenexa, KS 66219
913-945-5840
mjohnston@hwlochner.com

Director MathCounts

Rachel Henkhaus, PhD, P.E.
Garver
7301 W 129th Street
Suite 330
Overland Park, KS 66213
816-298-6465
REHenkhaus@GarverUSA.com

Awards

Ryan DaMetz, P.E.
Lochner
16105 W 113th Street, Suite
107
Lenexa, KS 66219
913-945-5840
rdametz@hwlochner.com

Chapter Leadership

Membership

Allison Bruner , P.E.
TREKK Design Group
1411 E 104th Street
Kansas City, MO 64131
816-877-8686
abruner@trekkdesigngroup.com

Fundraising

Rodney M. Holcomb, S.E.,P.E.
Burns & McDonnell
9400 Ward Parkway
Kansas City, MO 64114
816-349-6693
rholcomb@burnsmcd.com

Engineering Preparation

Tawn Nugent, P.E.
TREKK Design Group
1411 E 104th Street
Kansas City, MO 64131
816-877-8684
Tnugent@trekkdesigngroup.com

Advertising

Kristen Leathers, P.E.
Affinis Corporation
7401 West 129th Street,
Suite 110
Overland Park, KS 66213
913-239-1122
kleathers@affinis.us

Community Service

Anne Schroer, P.E.
GBA
One Renner Ridge
9801 Renner Boulevard
Lenexa, KS 66219-9745
913-577-8257
aschroer@gbateam.com

Executive Secretary

Nicolle Downing
jaindowning@gmail.com
816-294-9563

Professional Directory



We're invested
 in Kansas City.



Learn how Garver is encouraging the next generation of engineers in Kansas City at GarverUSA.com/Centennial.



CELEBRATING ONE HUNDRED YEARS
 1919 to 2019



SCHLAGEL & ASSOCIATES, P.A.
 Engineers • Planners • Surveyors • Landscape Architects

*Proudly serving our clients
 for over 35 years*

www.schlagelassociates.com



CROSSINGS. CULVERTS. BRIDGES. CONTECH.

CONTECH
 ENGINEERED SOLUTIONS
www.ContechES.com

C. Todd Black, P.E.
 Senior Bridge Consultant – KS, MO, NE
 913-216-3818
tblack@conteches.com



Affinis
 corp
 Moving Communities
 Forward



913-239-1100
www.affinis.us

Professional Directory



LAMP RYNEARSON
 Formerly Larkin Lamp Rynearson

Your *engineering partner* for
 civil design, water, wastewater,
 and aquatics projects.

9001 State Line Rd., Ste. 200
 Kansas City, Missouri 64114
 816.361.0440
 LampRynearson.com

LEAVING A LEGACY OF ENDURING IMPROVEMENTS
 TO OUR COMMUNITIES

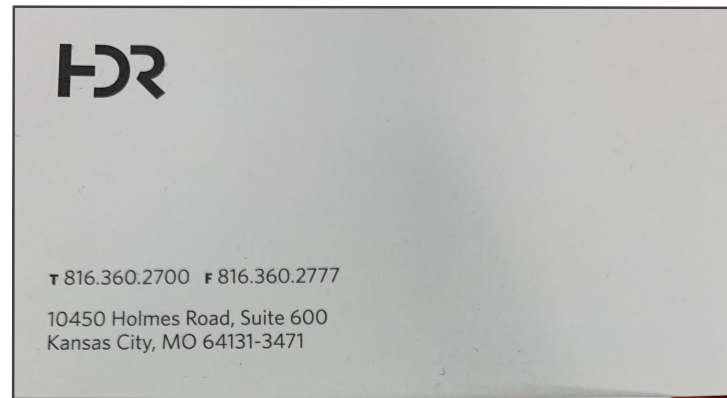

HDR

☎ 816.360.2700 ☎ 816.360.2777

10450 Holmes Road, Suite 600
 Kansas City, MO 64131-3471



HNTB

KANSAS
 7400 W. 129th St., Ste. 100
 Overland Park, Kansas 66213
 913.491.9333

MISSOURI
 715 Kirk Drive
 Kansas City, Missouri 64105
 816.472.1201

100+ YEARS OF INFRASTRUCTURE SOLUTIONS WWW.HNTB.COM